

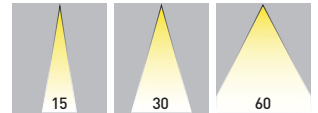

IK 09
IP 66



Mini Reef MCL

- Corpo orientabile in pressofusione di alluminio.
- Staffa regolabile verniciata.
- Verniciatura in poliestere con pretrattamento speciale per esterni.
- Vetro trasparente.
- Bloccacavo in ottone nichelato PG11.
- Guarnizioni in silicone resistente ad alte temperature.
- Cavo di alimentazione lunghezza 2 m.

- Adjustable body made of die-cast aluminium.
- Adjustable bracket painted.
- Polyester painted with pre-treatment for outdoor use.
- Transparent glass.
- Cable gland of nickel plated brass PG11.
- Silicon gasket high temperature resistant.
- Power cable length 2 m.



					(W)	(lm)	(V)	(K)
Br	E1080-LBC	E1074-LBC	E1077-LBC					
Ne	E1081-LBC	E1075-LBC	E1078-LBC		31W	3700	220-240V	3000
Gr	E1082-LBC	E1076-LBC	E1079-LBC					
Br	E1080-LBN	E1074-LBN	E1077-LBN					
Ne	E1081-LBN	E1075-LBN	E1078-LBN		31W	3870	220-240V	4000
Gr	E1082-LBN	E1076-LBN	E1079-LBN					

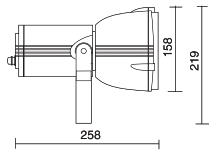

2,80 kg

ACC.	Br	Ne	Gr	
	E1067	E1068	E1069	Palpebra - Eyelid
	E1031			Picchetto inox - Inox pike
	E1070	E1071	E1072	Aletta singola max 4 - Single flap max 4

