

Vandaguard LED with Lumen Select

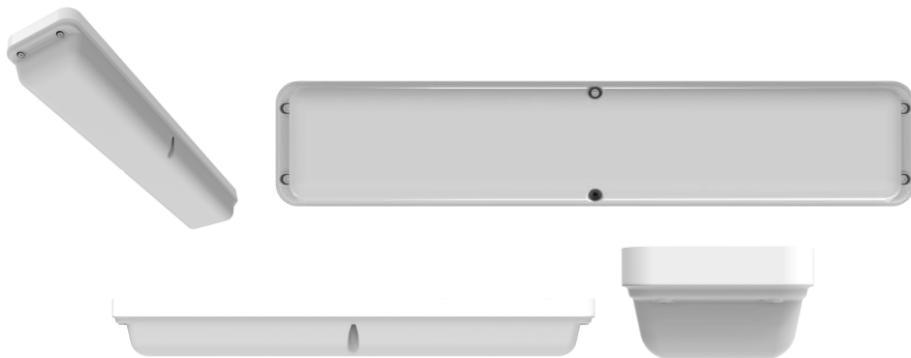

PLEASE READ THESE INSTALLATION INSTRUCTIONS CAREFULLY BEFORE INSTALLING OR MAINTAINING THIS EQUIPMENT. THE PRODUCT IS DESIGNED FOR INSTALLATION AND MAINTENANCE IN ACCORDANCE WITH RELEVANT AUSTRALIAN STANDARDS (AS/NZ3000), THESE INSTRUCTIONS AND LOCAL REGULATIONS (WHERE APPLICABLE), BY AN AUTHORISED AND LICENCED ELECTRICIAN. THE INSTALLATION INSTRUCTIONS WERE CORRECT AT THE TIME OF PRINT. TO REFLECT CHANGES IN TECHNOLOGY AND AUSTRALIAN STANDARDS; GPS RESERVES THE RIGHT TO AMEND THE INSTRUCTIONS WITHOUT NOTICE. UPDATED GUIDELINES CAN BE FOUND ON RELEVANT BRAND WEB SITE.

IMPORTANT - THE PRODUCT MUST BE MAINTAINED AND OPERATED IN ACCORDANCE WITH THE MANUFACTURER'S INSTRUCTIONS, FAILURE TO DO SO MAY DAMAGE THE PRODUCT AND SERVICES. IT IS STRONGLY RECOMMENDED THAT THIS IMPORTANT NOTE BE COMMUNICATED TO THE OWNER AND OR OPERATOR OF THE INSTALLATION AT THE TIME OF SITE COMMISSIONING. GOOD PRACTICE DOES NOT RECOMMEND THE 24/7 USE OF PRODUCTS WITHOUT THE APPLICATION OF SUITABLE SWITCH CYCLE INTERVALS. GPS IS NOT RESPONSIBLE FOR ANY PRODUCT NOT MAINTAINED IN ACCORDANCE WITH THE RECOMMENDED PROCEDURES. ALL PRODUCTS SHOULD BE THOROUGHLY CLEANED ON A REGULAR BASIS TO ENSURE THE OPTICAL PERFORMANCE, TOGETHER WITH THE ELECTRICAL, MECHANICAL AND STRUCTURAL INTEGRITY AS DESIGNED, IS MAINTAINED THROUGHOUT THE SERVICE LIFE OF THE PRODUCT.

LUMEN SELECT

**RAPIX
READY**



1. PRODUCT SPECIFICATION:

Type of protection	Class I luminaire
IP rating	IP66
IK rating	IK10
Nominal voltage	240V
Nominal frequency	50 Hz
Number of wattages per fitting	5
Available wattages	65W selectable through driver din switch
(52W set as default, please see wattage settings for directions for other wattages)	55W set as factory default on ordered fitting
	38W selectable through driver din switch
	35W selectable through driver din switch
	23W selectable through driver din switch
Power factor	>0.8
Circuit wattage	Refer table in section 4
Inrush current	Cold start 10A(twidth=2001µs measured at 50% Ipeak) at 230VAC
Earth leakage	0.5Ω
Rated operating ambient temperature	0 to +40°C
LED lifetime (L70) rated	>60,000 hours
Colour temperature	4000K
Colour rendering index (CRI)	80
LED control gear	DALI
Sensor available	Yes
Available in emergency	Yes, DALI and self-testing
Emergency battery technology	4-hour Lithium Iron Phosphate (LiFePO4)
Electrical connection	Direct to terminal block
Cable entry	Rear mounted center access via 25mm hole
Installation orientation	Surface
Dimensions (LxWxH)	Refer to table in section 6
Net weight of luminaire	Refer to table in section 6

2. CONSUMABLES

Description	Pierlite's Replacement Part Number	QTY Required Per Fitting	Brand	Component Part Number	Dimensions (LxWxH) mm
2 amp fuse	99002353	1	Cooper Bussmann	TDC180-2A	25.4x6.3x6.3
4 hour Lithium Iron Phosphate (LiFePO4)	BATPK3200/3L31	1	Pierlite	BATPK3200/3L31	80x70x28

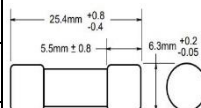

3. LUMEN SELECT METHODOLOGY

Fitting Type	Diffuser	Wattage	Fitting Size	Control gear	Colour Temperature	Sensor Type	Emergency	Night light	Government Spec
VG = Vandaguard	O = Opal	LS = Multi Wattage - Factory default = 55W	4 = 4 foot (1200mm)	D = DALI	4 = 4000K 3 = 3000K A = Amber G = Green B = Blue	M = HF sensor	S4 = Sustained 4hr	N = Night light	PB = Public works

4. ELECTRICAL CHARACTERISTICS

4000K

SKU to Order	Selectable Wattages by Dip Switches (W)	Line Current (A)	Night Light Wattage (W)	Night Light Line Current (A)	Colour Temperature	Fuse and Surge Protector	Emergency	Sensor	Night Light	Factory Default Setting
VGOLS4D4	65	0.29	No Night Light		4K	No	No	No	No	
	55	0.24				No	No	No	No	Yes
	38	0.179				No	No	No	No	
	32	0.148				No	No	No	No	
	23	0.112				No	No	No	No	
VGOLS4D4S4	69	0.3	No Night Light		4K	No	Yes	No	No	
	58	0.27				No	Yes	No	No	Yes
	42	0.21				No	Yes	No	No	
	35	0.18				No	Yes	No	No	
	26	0.14				No	Yes	No	No	
VGOLS4D4M	65	0.29	No Night Light		4K	No	No	Yes	No	
	55	0.24				No	No	Yes	No	Yes
	38	0.179				No	No	Yes	No	
	32	0.148				No	No	Yes	No	
	23	0.112				No	No	Yes	No	
VGOLS4D4N	65	0.29	2.8	0.183	4K	No	No	No	Yes	
	55	0.24				No	No	No	Yes	Yes
	38	0.179				No	No	No	Yes	
	32	0.148				No	No	No	Yes	
	23	0.112				No	No	No	Yes	
VGOLS4D4MS4NPB	69	0.3	2.8	0.183	4K	Yes	Yes	Yes	Yes	
	58	0.27				Yes	Yes	Yes	Yes	Yes
	42	0.21				Yes	Yes	Yes	Yes	
	35	0.18				Yes	Yes	Yes	Yes	
	26	0.14				Yes	Yes	Yes	Yes	

5. LUMINAIRES PER CIRCUIT BREAKER

Miniature Circuit Breaker	QTY
Drivers per MCB 10A Type B	17
Drivers per MCB 16A Type B	27
Drivers per MCB 20A Type B	34
Drivers per MCB 25A Type B	42
Drivers per MCB 10A Type C	20
Drivers per MCB 16A Type C	32
Drivers per MCB 20A Type C	40
Drivers per MCB 25A Type C	50
Drivers per MCB 10A Type D	22
Drivers per MCB 16A Type D	36
Drivers per MCB 20A Type D	45
Drivers per MCB 25A Type D	57

*The quantity of luminaires per circuit breaker is a guide only, this information may change

6. LINE DIAGRAMS AND DIMENSIONS

Fitting Size	Length in mm	Width in mm	Height in mm	Weight in Kg
4 foot	1308	137	83	8

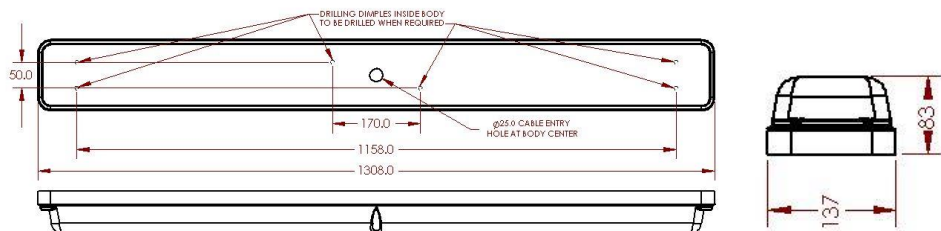

9. DALI CONTROL GEAR: The LED driver and emergency control gear are both controllable through the DALI RAPIX system. A DALI connection is not required in a non-systemized electrical system, if DALI is not required do not connect it.

Note: when designing the DALI system please refer to the table below for the number of DALI addresses.

Control gear	Function	Number of Addresses	RAPIX Ready
LED Driver	Dimming, on/off & feedback	1	YES
Emergency Inverter	Testing & Reporting	1	YES

10. APPROVALS: The RCM marking of this product applies to AS/NZS CISPR15 (EMC) "Limits and methods of measurement of radio disturbance characteristics of electrical lighting and similar equipment". This product is designed to conform to AS/NZS60598 "Luminaires, general requirements and tests".



11. STORAGE: Prior to installation products are to be stored in cool and dry conditions.

12. APPLICATION: The installation application and orientation of the product is designed in accordance with the nominated product IP rating, class designation and these installation installations. Installation environments outside these conditions are not recommended.





13. INSTALLATION / GENERAL: Installation of the product is to be completed by an authorized and licensed electrician, in accordance with these instructions, relevant Australia standards and local regulations (where applicable). Termination of product wiring, together with the installation of the product must be in a manner that maintains the integrity of the designated IP rating of the product for electronic control equipment (when supplied) DO NOT MEGGER between A and N.

14. LUMEN SELECT (contractor selectable output)

Pierlite's lumen select products allows all licensed electricians to purchase one luminaire that can be set as multiple fixed wattages/ fixed lumen outputs. By offering this capability within one fitting it provides the following benefits

- One fitting multiple fixed outputs
- Less stocked items
- One fitting on the shelf or in the van
- Variable onsite options
- Easy to change settings
- IES files available for all available for wattages shown in the below table
- No control system or software required to change fixed output

The Vandalux luminaire and retrofit kit has been factory set to 55W/7033lm, if a different wattage/lumen output is required the licensed electrician can easily change the driver dip switches to the settings shown in the below table.

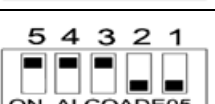
System Wattage (W)	Driver Settings (mA)	Lumen Output (lm)	Driver Dip Switch Settings
65	1400	8203	
55W (factory default setting)	1150	7033	
38	850	5159	
32	700	4282	
23	500	3113	

15. INSTALLATION / GENERAL: Installation of the product is to be completed by an authorized and licensed electrician, in accordance with these instructions, relevant Australia standards and local regulations (where applicable). Termination of product wiring, together with the installation of the product must be in a manner and orientation that maintains the integrity of the designated IP rating of the product for electronic control equipment (when supplied) DO NOT MEGGER between A and N.

Installation:

Ensure the appropriate bracket has been ordered for your installation type. Refer to the bracket installation instructions for further information.

- a) Isolate the supply circuit as per the Australian standard and your SWMS.
- b) Remove both the diffuser and the gear tray using a 5mm hex head and place in a safe location to ensure the product does not get damaged while the housing is being installed.
- c) Install the housing with the selected bracket system.
- d) Suspend the gear tray from the lanyards
- e) Connect the supply wires to the supplied 6mm² terminal block. Ensure sure all connections and cabling complies to AS3000.
Note: Ensure the correct cables and wires go to the correct terminals as per below
 - Luminaire with only general/mains lighting
 - Connect to active, earth and neutral
 - Luminaire with night light
 - Mains light to
 - Mains switched active to A1 terminal
 - Mains neutral to N1 terminal
 - Night light to
 - Night light switched active to A2 terminal
 - Night light neutral to N2 terminal
 - Luminaire with emergency
 - Mains switched active to A terminal
 - Mains neutral to N terminal
 - Emergency to
 - Emergency active to UnSWA terminal
 - The emergency neutral is a shared terminal with mains neutral
- f) Select the wattage/lumen output by changing the dip switches on the LED driver, please refer to section 12 of this installation sheet.
Note: 55W/7033lm is the factory default for this fitting.
- g) Secure the gear tray to the luminaire body ensuring all cables a clear from pinching or possible damage.
- h) Tighten the screws securing the gear tray to a maximum of 4Nm
- i) Installation of the diffuser, lightly screw the supplied hex head screws into the 6 holes around the diffuser. Place diffuser to the body and tighten screws to a maximum of 4Nm.
- j) Ensure the IP rating of the installation is equal to that of the tested IP rating of the fitting. **Note:** The IP rating of the fitting is IP66.
- k) Test fitting as per the relevant Australian standard and as per your SWMS.

16. Service & Operation (Emergency Version)

Normal Operation: Maintained Emergency Operation.

Battery: Sealed **Lithium Iron Phosphate (LiFePO4)** rechargeable battery pack. As per AS/NZS 2293, it is required that the battery pack is discharged and recharged at least once every 6 months.

In case of a replacement, same brand and type of battery pack must be used. Allow 24 hours charging time before carrying out any discharge tests.

Charge Duration: 16 Hours

Discharge Duration: 4 Hours (Initial Test)

Test Switch: If manual test switch pressed, the fixture will operate from its battery supply. Please ensure battery plug is connected to the inverter battery terminal.

17. MAINTENANCE:

(a) The supply must be isolated before opening or accessing the luminaire. Product maintenance is IMPORTANT and is critical to the products designed performance. The product is to be maintained in accordance with the manufacturer's instructions. For the latest product maintenance guides please go to relevant brand web site. GPS is not responsible for any product not maintained in accordance with the recommended procedure or intervals.

(b) Lamps (where provided): The product is designed with the supplied (LEDs) / LAMP/s and it is strongly recommended that any LAMP / (LEDs) changes (if any) be made in accordance with the type, colour and brand supplied. For recommended LAMP / LED maintenance or operating guides (inclusive of recommended product switch cycles and mandatory run-in procedures for HID and Fluorescent lamps when used with dimming circuits), GPS recommends the application of the lamp manufacturer's operating guidelines, which can be found on manufacturer's website. GPS is not responsible for the product performance of alternative lamp/s used. As a member of FluoroCycle, we encourage recycling of lamps and components.

(c) Battery (where provided): The battery is designed with a rated average battery design life of 50,000 hrs. in standby mode. The battery is supported with a standard **Four (4) year warranty**, conditional of the product being maintained and operated in accordance with the

manufacturer's guidelines and tested in accordance with AS/NZS2293. For guidelines see product installation instructions or visit the relevant brand web site.

(d) For products supplied with glass visors or covers, do not operate the product with a damaged visor or cover; it is recommended the product be turned off, area surrounding the product vacated and the damaged glass replaced by a professional installer immediately.

18. WARRANTY INSTRUCTIONS: For the purpose of warranty claims (if any) the following instructions apply:

Warranty period - The above components are provided with a warranty of **Five (5) years** against manufacturing defects or failure to perform to specifications for products installed by an authorised installer in accordance with the manufacturer's installation instructions and which have not been subject to incorrect operation or maintenance, unauthorised modification or damage arising from any intervening cause.

Warranty reference - The warranty reference date commences from the date of purchase.

Warranty point of contact - Gerard Professional Solutions Pty Ltd, 96 Gow Street Padstow NSW 2211, phone T 1300 799 300 contact - GPS After Sales Support.

Warranty claim procedure - For the purpose of making a claim the customer must:

1. Contact the "point of contact" above and upon provision of proof of purchase the customer will receive a goods return advice (GRA) number. 2. At the customer's expense, collect and return the goods to the "point of contact" with the issued GRA number. 3. Upon receipt of the goods, GPS will review the claim and if found to be accepted, GPS will return a replacement product to the customer to install at the customer's expense.

Alternatively, if the claim is rejected, the customer may request the return of the goods at their expense. **Consumer Contracts** - The benefits to the customer given by the GPS warranty are in addition to other rights and remedies of the customer if the goods are the subject of a Consumer Contract under the Australian Consumer Law. In that event the following statement is required to be brought to the Consumer's attention: - *Our goods come with guarantees that cannot be excluded under the Australian Consumer Law. You are entitled to a replacement or refund for a major failure and for compensation for any other reasonably foreseeable loss or damage. You are also entitled to have the goods repaired or replaced if the goods fail to be of acceptable quality and the failure does not amount to a major failure.* **Limitation of Liability** - if the goods are not purchased by the customer under a Consumer Contract within the Australian Consumer Law then but not otherwise;- (a) the Company is not liable in tort for any loss or damage suffered by the customer or by any third party; and (b) in no circumstances is GPS liable to the customer or to any third party for any loss of profits, loss of anticipated savings, economic loss or interruption of business or for any indirect or consequential loss (Consequential Loss).

Terms of Sale - these Warranty provisions are in substitution for any inconsistent provisions in the GPS Terms and Conditions of Sale in so far as they apply to the Warranty components.